

CAMPING DE LA PLAGE – PRICE 2021

RENTAL RATES 1 NIGHT / Package 1 to 4 pers / 5€ by additional person (1/2 max)					
Period	Chalet Fabre	Mobilhome Lodge	Mobilhome IRM&Helios	Mobilhome California	Tent Lodge
Except 10/7-27/8	72 €	83 €	65 €	62 €	57 €
10/7-23/7 21/8-27/8	95 €	114 €	90 €	85 €	75 €
24/7-20/8	120 €	144 €	115 €	110 €	90 €

RENTAL STAY ≥ 2 nights Package 1 to 4 persons Arrival 4 pm / Check out to plan from 8:30 pm to 10 am					
Chalet Fabre	55 €	60 €	70 €	90 €	116 €
Mobilhome Lodge	63 €	69 €	81 €	108 €	139 €
Mobilhome IRM & Helios	49 €	54 €	64 €	85 €	109 €
Mobilhome California	44 €	50 €	61 €	80 €	104 €
Tent Lodge Victoria	41 €	47 €	54 €	70 €	87 €
Additional person	5 €	5 €	5 €	5 €	5 €

DISCOUNTS (except options & tourist taxes, except Dormitory & Rando Tents)	
Rental reduction couple 1 week	: - 30 € except from 10/07 to 27/08
Rental & Pitch stay ≥ 2 weeks (except ACSI/ANWB/ADAC prices)	: - 5 %
Pitch	: ACSI 18 € except July & August - FFCC -10%/ -5% in low/high season

DORMITORY TENT to share - 3 bunk beds => 6 beds You can share this tent with other guests and/or passing pilgrims.	
April, May, June, September & October	12 € / night / person / bed
July & August	14 € / night / person / bed

RANDO Tents – 2 tents (1/2 persons) on the same pitch					
For 1 night	17/04 09/07	10/07 23/07	24/07 20/08	21/08 27/08	28/08 02/10
1 person	20 €	25 €	30 €	25 €	20 €
2 persons	30 €	40 €	45 €	40 €	30 €

HIKERS COMMON AREA – 4 tents max on 1 pitch (without vehicle)	
17/04 - 09/07 & 21/08 - 02/10	8€/1 pers/1 night – 14€/2 pers/1 night
10/07 – 20/08	12€/1 pers/1 night – 22€/2 pers/1 night

CAMPING PITCH – RATES 1 NIGHT For 1 person, 1 motorhome / 1 car + tent(s) / 1 car + 1 caravan With max 1 vehicle and 7/8 persons per pitch Nature/Large pitch Arrival : from 2:30/2:00 pm in low/high season	
Nature without electricity (1 person)	10 € 17 €
Large pitch (≥ 130m ²) without electricity (1 person)	15 € 22 €
Electricity	5 € 5 €
Additional person (≥ 12 years)	6 € 7 €
Additional person (2/11 years)	3 € 5 €
Child (< 2 ans)	Free free
Water tap and drain for waste	free free

SUPPLEMENTS	
Deposit : entry badge (20 €), rental (300 €) - by cash, bank check, credit card	
No administration fees - Tourist taxes : 0,55 € per day/adult	
Chalet/Mobilhome : free TV	
Animal 3€/4€ per night for rental in low/high season - 2.50 €/night for pitch	
Visitor : registration and authorization at reception	
Cancellation insurance : FFCC (78 rue de Rivoli - 75004 Paris - 01.42.72.90.08)	

SERVICES
Restricted Wifi : free access around reception, chalet TV/WIFI/library in open access
Rental cleaning package (60€), disposable sheet set (6€), washing token (4€), dryer tokens (4€), washing powder (1€)
Fridge (on stock/reservation) : 5€/day, ventilator (on stock/reservation) : 5€/day, self-service freezer at the reception for ice buns
Equipment loan (on stock/reservation) with deposit : baby bed, highchair, baby bath & changing pad, adapter, extension cord, iron, kettle, toaster
Free parking for additional car
TTC Price - Heating, hot water & charges included
Payments by cash, bank check, credit card and bank transfer

For your comfort and leisure ...

PUBLIC BEACH

Bathing, bar-snack
Leisure center (high season) : canoes, pedalos, paddles, fishing,
Water slipway

RECEPTION

Opening : - 8:30 am – 6:00/7:00 pm in low season
- 8:30 am - 7:00 pm in high season

FRIENDLY SPACE : Wifi access, TV, books

3 TOILET BLOCKS with 1 for reduced mobility person, individual cabins, baby spaces

LAUNDRY : washing and drying machines, ironing board

COLLECTIVE BARBECUE and picnic tables on playground

PLAYGROUND : cross park, home ball, multi games front wall, trampoline, ping-pong, volley, badminton, petanque field

GUARD at place

ENVIRONMENT : selective sorting

SHOPS

- On site : Bread & pastries, ice creams, drinks, chips, ... to take away
- At 900 m and 1,5 km : Food store, bakery with tobacco & press, petrol station, restaurants, shops, local markets, ...

HIKING

Access to village and towpath on foot, on bike, on cruise
Many hiking trails

For everyone and in family ...

PARTNER REDUCTIONS

Castle, canoeing, speleology, riding, cruise ...

FREE ENTERTAINMENTS IN HIGH SEASON

Activities 6-12 and teenagers, cinema, games, sport tournaments, tours ...

PAID ACTIVITIES IN HIGH SEASON

Canoes, pedal boats, paddles ...

CAMPING DE LA PLAGE

Porte Roques 46330 Saint-Cirq-Lapopie

00 33 (0)5 65 30 29 51

www.campingplage.com

Siret 80115971600019 - Tva FR65801159716 - Ape 5530z



Welcome in our Family Campsite.
Located at the foot of the classified site
of St. Cirq Lapopie,
in the heart of the Regional Park,
3 hectares reveal you a panorama
in harmony with nature.
You will find peace, friendliness
and quality of many activities
for your enjoyment and well-being.

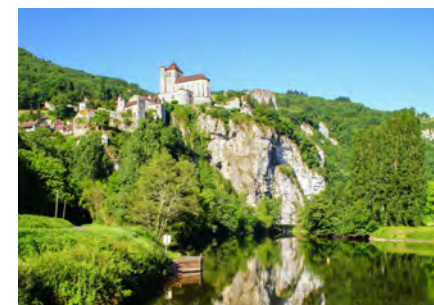

« A small corner of paradise
in a beautiful setting »

Cathy & Mickaël, Magalie & Sébastien

90 delimited pitches
Hikers common area
30 rentals : Chalets, Mobilhomes, Lodge Tents,
Rando Tents, Dormitory Tent
Bar/ Snack / Restaurant
Playground, Free Wifi
Public beach, Swimming
Animations



PITCHES



CHALETS



LODGES TENTS

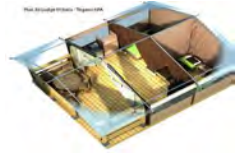

MOBILHOMES



RANDO TENTS



DORMITORY TENT

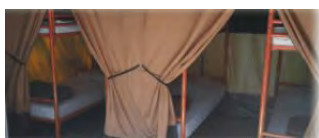

2 equipped toilet blocks (1 heated), baby area, child block
1 PMR toilet block for reduced mobility person
Laundry : washing and drying machines, ironing board
Electricity, water terminals, area drain, chemical toilet, water

Hikers common area : 4 tents max (1/2 persons) without vehicle

CHALET FABRE (± 37 m² - 4/6 persons - covered terrace)
1 living room kitchen with 1 sofa bed for 2 persons
1 bedroom : 1 bed 2 persons
1 bedroom : 2 beds 1 person
Bathroom, separate toilet

TENT LODGE VICTORIA (± 30 m² - 4/5 persons)
1 bedroom : 1 bed 2 persons
1 bedroom : 1 bed 2 persons + 1 loft bed 1 person
1 living room kitchen opened on the terrace (fridge + gas + microwave)
1 covered terrace with garden furniture

MOBILHOME LODGE (± 32 m² excluding terrace - 6/8 persons)
1 living room kitchen with 1 sofa bed for 2 persons
1 bedroom : 1 bed 2 persons, 2 bedrooms : 2 beds 1 person
Bathroom, separate toilet
1 semi-covered terrace with garden furniture and 2 sunbeds

MOBILHOME IRM (± 27 m² - 4/6 persons)
1 covered terrace (25m²) with garden furniture and 2 sun loungers
1 living room kitchen with 1 sofa bed for 2 persons
1 bedroom : 1 bed 2 persons, 1 bedroom : 2 beds 1 person
Bathroom, separate toilet

MOBILHOME IRM HELIOS for reduced mobility person
± 32 m² - 4/6 persons with at least 1 child (≥ 6 years)
1 living room kitchen with 1 sofa bed for 2 persons
1 bedroom : 2 beds 1 pers, 1 bedroom : 1 bed 1 pers + 1 child loft bed
Bathroom with toilet (equipped for disabled person)

MOBILHOME CALIFORNIA (± 27 m² - 4/7 persons including 1 child < 1,60m)
1 covered terrace with garden furniture
1 living room kitchen with 1 sofa bed for 2 persons
1 bedroom : 1 bed 2 persons, 1 bedroom : 2 beds 1 person + 1 child loft bed for 1 child ≥ 6 years and <1,60m
Bathroom & separate toilet

RANDO TENT : 2 tents (1/2 persons) on the same pitch
2 beds 1 person, electricity, 1 pillow & 1 duvet per bed
Terrace with 1 table and 2 chairs

DORMITORY TENT to share
3 loft beds => 6 beds with 1 pillow & 1 duvet per bed
1 kitchen area with 1 microwave, terrace with table and chairs

IN RENTALS

Kitchenette : dishes kit, fridge, stainless sink, microwave, cooktops, cupboards.

Cleaning : broom, brush, shovel, bucket, basin, mop.

Bed pad, duvet and pillow for each bed.

Separate bathroom and toilet (except for tents).

Radiator (except for tents).

Pitch : 1 car near, wooded area, garden furniture, drying rack, TV (except for tents)

Are not provided: cleaning products, toilet paper, towels and sheets trimmings.

RESPECT CONTRAT CONDITIONS

Campsite rules are displayed in the reception.

Campsite barrier is closed from 11 pm to 7 am.

Opening hours are displayed in the reception.

VISITORS should ask permission to visit at the reception.

PITCHS must be vacated for **11h45**.

RENTALS no smoking, INVENTORY CHECK OUT from 8:30 to 10 am.

On arrival, take a check out appointment.

DEPARTURE CLEANING

Rental and pitch must be returned cleaned.

ANIMALS are allowed under the owner's supervision and are forbidden in public places. They are leashed and feces are collected. It's forbidden to leave them alone in rentals and on pitches.

SUSTAINABLE DEVELOPMENT APPROACH

For the good of all, thank you to take care to environment and energies economy.

NEARBY

30 km from Cahors, train station, airfield

Bus line Figeac-Cahors, bus stop : Tour de Faure (800 m)

Tour de Faure (900 m) : food store, bakery with tobacco & press, petrol station, garage, restaurants, ...

Saint Cirq Lapopie 1,5 km (pedestrian access) : cash machine, shops, galleries, restaurants, post office, tourism office, ...

Sport activities, hiking, canoe, speleology, canyoning, VTT, climbing, horse riding, ...

Regional natural park, tourist and artistic tours.

Cultural and festive evenings, gastronomy, markets ...